

6 Add user codes (8 max)

Programming Timeout

If no button is pressed for five seconds, the system will time out and you will need to restart the procedure.

A Make sure the door is open. Press the Program button the number of times that corresponds to the user code position being programmed.

Example: If programming the third code, press the button three times.

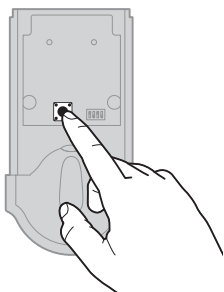

B Enter user code. A total of 8 user codes may be programmed.

Each user code must be a unique code between 4 and 8 digits.

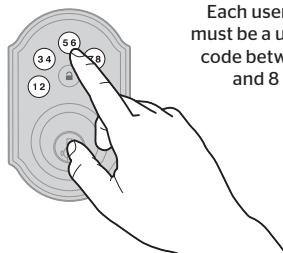

C Press Lock button once.

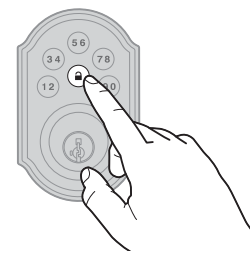

D What lights and sounds does the lock produce?

One green flash with one beep*

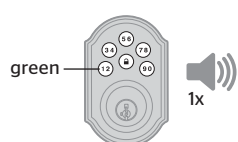

Programming was successful.

or

Three red flashes with three beeps*

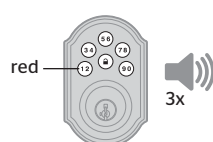

Programming was unsuccessful.

Make sure the user code is not a duplicate and that it is between 4 and 8 digits during your next attempt.

or

Two beeps*



Programming time out.

Make sure not to pause for more than 5 seconds during programming.

*Beeping sound will only be heard if switch #3 (on the lock interior) is in the on position. See "Switches and Status LED Colors" on page 4.

Mastercode

For enhanced security, a mastercode may be used when adding and deleting user codes. For more information about the mastercode, download the Programming and Troubleshooting Guide on the SmartCode 909 page at www.kwikset.com.

7 Test the lock (review normal operation)

Confirm that the code(s) added in previous step can unlock the door.

Locking the Door

Press Lock button once.

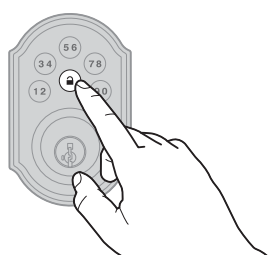

Unlocking the Door

Enter user code.

Tip: You can press the Lock button before entering your user code to light up the keypad at night.

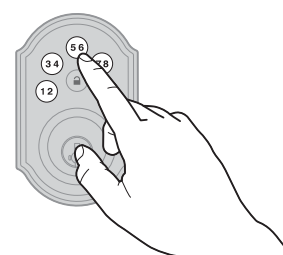

8 Re-key the lock (if needed) and install the battery cover

actual size  V

A Re-key the lock (if needed).

a

IMPORTANT: Remove battery pack before re-keying.

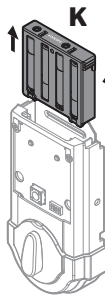

b

Re-key the lock to work with your existing key. See the supplied SmartKey Re-key instructions for more information.

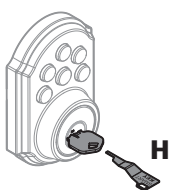

c

Reinstall battery pack.

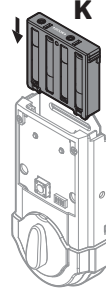

B Install the battery cover.

a

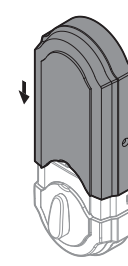

b

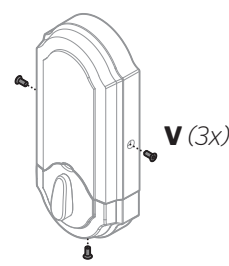

SmartCode at a Glance

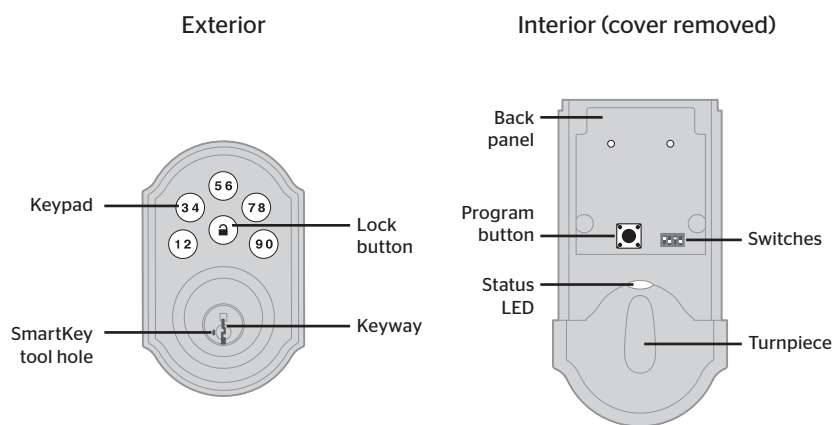

System Alerts

| Alert | Reason | Solution |
|--|--|--|
| Keypad flashes red 1 time with 1 beep* | Door jammed while attempting to lock. | Manually re-lock door. If needed, reposition strike. |
| Keypad flashes red 3 times with 3 beeps* | Unsuccessful programming. | Attempt programming procedure again. |
| | One incorrect code entered. | Re-enter code. |
| | No user code programmed. | Program at least one user code. |
| Keypad flashes red 10 times with 10 beeps* | Low battery. | Replace batteries. |
| Lock beeps 2 times. | Programming timeout. | Attempt programming procedure again, making sure not to pause for more than 5 seconds. |
| Keypad flashes red 3 times. | | |
| Keypad flashes red 6 times with 6 beeps*. | | |
| Keypad flashes red 15 times with 15 beeps* | Three incorrect codes entered within one minute. | Re-enter code after 60 second keypad lockout. |

*Beeping sound will only be heard if switch #3 is on.

Switches and Status LED colors

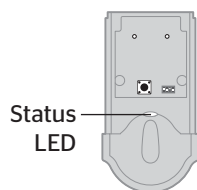
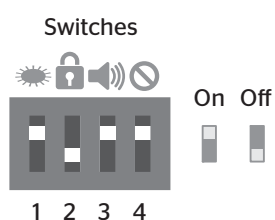

| Switch | Function |
|--------|---|
| 1 | Door lock status LED blinks every 6 seconds |
| 2 | Lock automatically re-locks door 30 seconds after unlocking. Disabled if no codes are programmed. |
| 3 | Audio |
| 4 | Not used |

| Color | Lock Status |
|----------------|---|
| Blinking green | Unlocked |
| Blinking amber | Locked |
| Blinking red | Low battery |
| Solid red | Door handing process did not work properly. See the online Programming and Troubleshooting Guide. |

Troubleshooting

A complete SmartCode 909 Programming and Troubleshooting Guide is available at www.kwikset.com.

Deleting a user code

In order to delete a user code, you must override the code by adding a different user code in the same position. For example, if you want to delete the third code, add a different user code in position three.

⚠ Test the old user code to make sure it can no longer unlock the door.

If you cannot remember the user code position, you may wish to perform a factory reset to delete all codes associated with the lock.

Factory Reset

A factory reset will delete all codes associated with the lock.

1 Remove battery pack.

2 Press and HOLD the Program button while reinserting the battery pack. Keep holding the button for 30 seconds until the lock beeps and the status LED flashes red.

3 Press the Program button once more. When the LED flashes green and you hear one beep, the lock has been reset.

4 Perform the door handing process again to teach the lock the orientation of the door, and add user codes to your lock.

Important Safeguards

1. Read all instructions in their entirety.
2. Familiarize yourself with all warning and caution statements.
3. Remind all family members of safety precautions.
4. Protect your user codes and mastercode.
5. Dispose of used batteries according to local laws and regulations.

⚠ **CAUTION:** Prevent unauthorized entry. Since anyone with access to the back panel can change the user codes, you must restrict access to the back panel and routinely check the user codes to ensure they have not been altered without your knowledge. The use of a mastercode can help protect your system's settings.

⚠ **WARNING:** This Manufacturer advises that no lock can provide complete security by itself. This lock may be defeated by forcible or technical means, or evaded by entry elsewhere on the property. No lock can substitute for caution, awareness of your environment, and common sense. Builder's hardware is available in multiple performance grades to suit the application. In order to enhance security and reduce risk, you should consult a qualified locksmith or other security professional.