

## Basic Programming Functions

Go to [schlage.com/faqs-touch](https://schlage.com/faqs-touch) for videos, more advanced programming instructions, and more. Register your product at [RegisterMySchlage.com](https://RegisterMySchlage.com).

### ADD OR REMOVE USER CODE

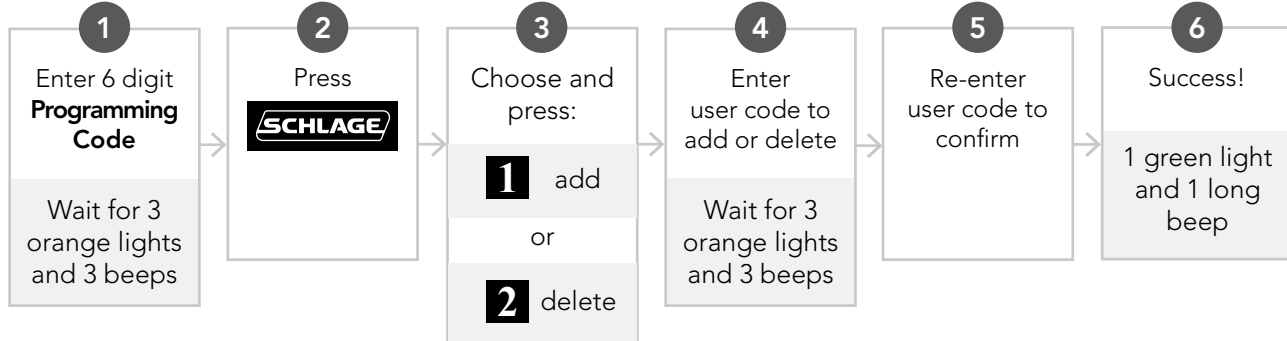

### CHANGE THE PROGRAMMING CODE

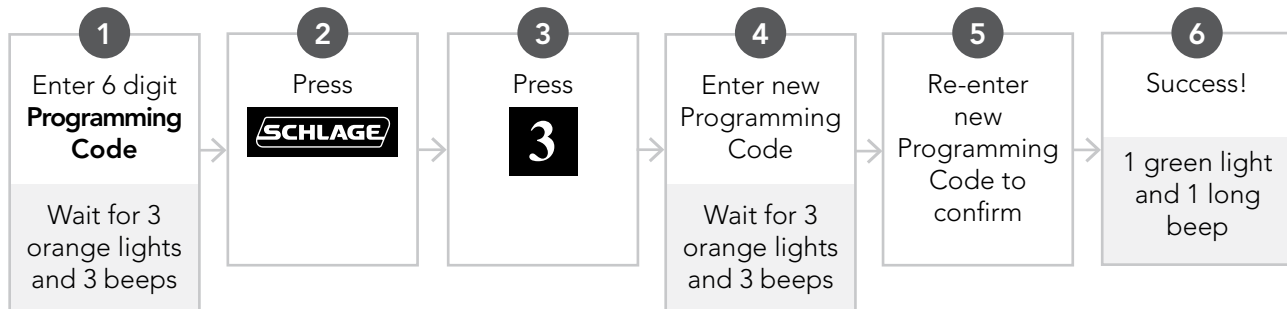

## Battery Jump

The emergency battery jump start can be used if your battery is dead to unlock your door. Do not remove the battery until you have opened your door.

**WARNING: The lock will remain unlocked until you change the battery or manually relock the door from the inside!**

1. Connect a new high-quality alkaline 9 volt battery to the contacts below the touchscreen keypad.  
» Keep the battery connected to the jump start contacts as you unlock your door.
2. Enter a User Code into the keypad.
3. Rotate the lever to open the door.

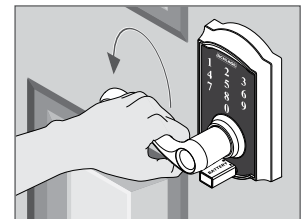
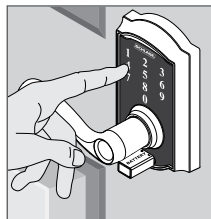
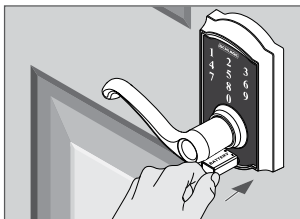

4. Replace the dead battery with the new 9 volt battery.

Questions about your new  
**Schlage Touch™**  
Keyless Touchscreen Lock?

**Please don't return it to the store!**

Let us help you first!



Scan for  
programming  
information, help,  
warranty, and more.

